

PISCATAWAY, NEW JERSEY

NU1



DFT

DuPONT FABROS
TECHNOLOGY

**DATA CENTERS
POWERED BY TRUST**

THE CENTER THAT NEVER SLEEPS

The greater New York metro area is a pulsing capital of industry and finance—alive 24 x 7 x 365 with critical transactions that shape our future. NJ1 keeps your business right in the heart of the action.

An ideal home for your IT assets and applications, NJ1 delivers metropolitan sophistication with the right mix of power, reliability, security and nonstop performance. You'll also benefit from flexible design options within our 360,000 square-foot space—offering a total of 36.4 megawatts of critical power capacity.

A Philosophy of Support

Your business is more than data. And DFT does more than house your servers.

We stop at nothing to support your mission.

That means designing data centers to deliver concurrently maintainable power and cooling, unequalled reliability, stalwart security and economic advantage. We apply our engineering and operational expertise to keep your costs down while maintaining 100% service level agreements. We deploy proven technologies and practices to deliver an unrivaled PUE and minimize our carbon footprint.

Our relentless focus on performance has resulted in an industry-leading 11.1 million megawatt hours of uptime.

Choose Your Network Carrier

Many of the most popular carriers are available at NJ1. In addition, NJ1 hosts an Internet Exchange, AMS-IX NY. If your choice of carrier isn't already in our building, we can invite them in on your behalf.

Benefit Your Bottom Line

The New York metro area is built for business. Anchored by Wall Street, the world's premier financial center, the region is a global hub for industries such as banking, insurance, healthcare, fashion, mass media and the arts.

With your IT infrastructure housed in NJ1, you'll be surrounded by green, from the cost savings recognized from the area's lowest power rates to the 2.0+ MW solar plant on the roof.

In addition, mass transit systems make NJ1 easily accessible from anywhere near and far.



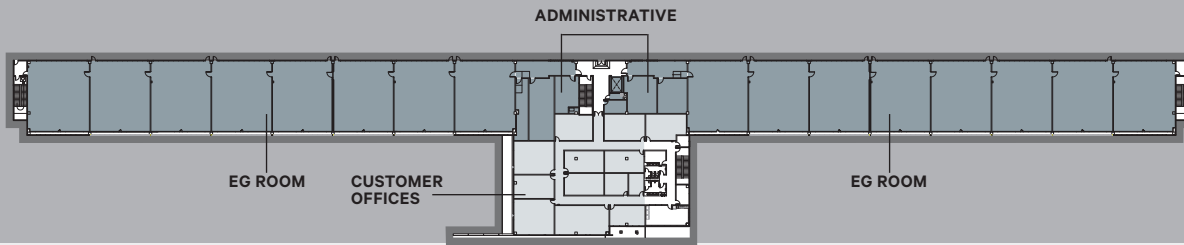

BUILDING

- 36.4 MW
- 360,000 SF
- 38 acres

POWER

- Design
- annual
- N+2 re
- system
- Scalab
- 568.75
- critica
- room

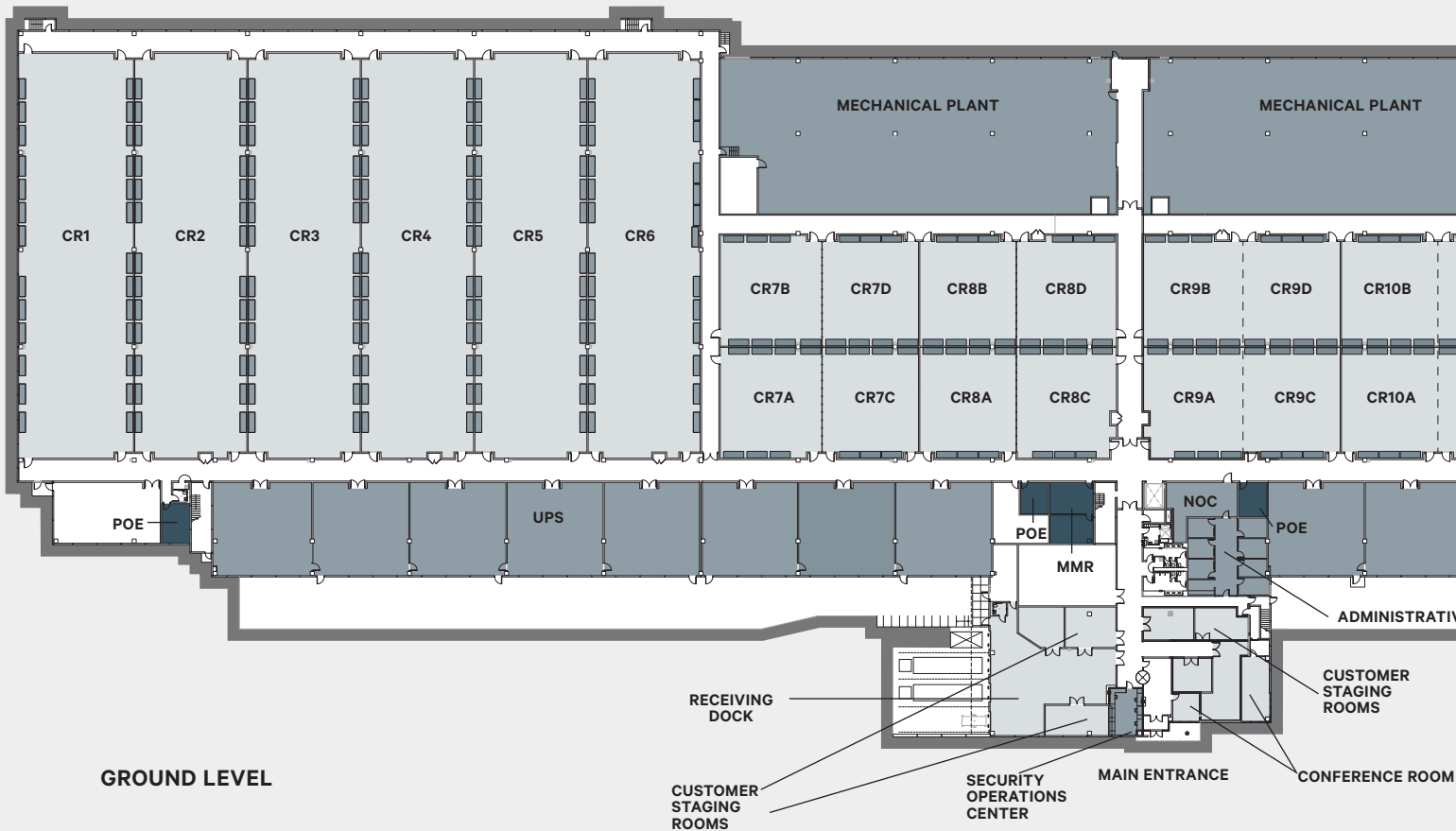

POWER & COOLING
• Low PUE of 1.28 at full capacity
• Utilized
• Redundancy for all building
• Systems at full capacity
• Scalable and flexible densities from
• 5 kW, 1,137.5 kW or 2,275 kW of
• Total IT capacity in each computer

SECURITY
• 24 x 7 x 365 security officers
• CCTV surveillance cameras
• Two-factor authentication and biometrics
access
• Security-fenced perimeter and main gate
with proximity card access

SUSTAINABILITY
• LEED Gold Certified
• 2.0+ MW solar plant

CONNECTIVITY
• Carrier-neutral
• Four separate network Points
of Entry (POE) with diverse
underground duct banks
• Meet-Me-Room (MMR) available
• Dark fiber available within data
center
• AMS-IX New York Internet Exchange

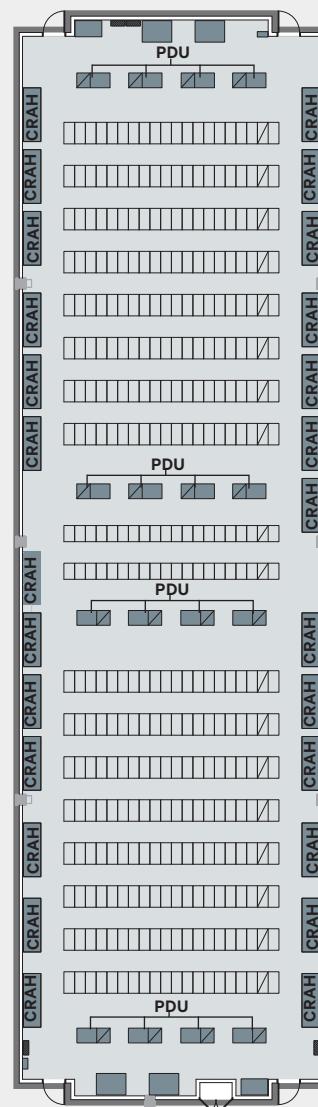
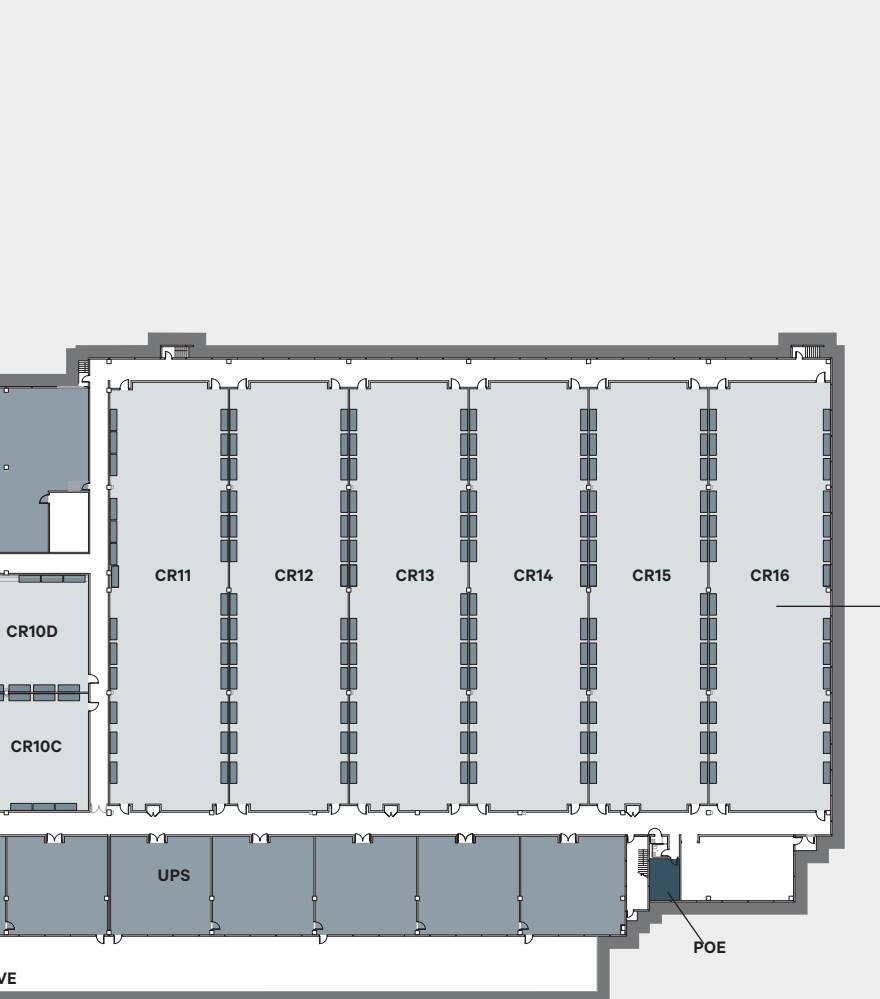

**COMPUTER ROOM WITH
OPTIONAL 2N PDU CONFIGURATION**
(360 2'x4' CABINETS SHOWN)



NJ1

SPECIFICATIONS

PROPERTY

Location: Piscataway, NJ
Acreage: 38
Building Size: 360,000 SF
Nearest Airport: Newark Liberty International Airport (EWR)

BUILDING DESCRIPTION

Utility Power: 69.0 kV
Parking: 200+ spaces
Number of Stories: One, plus customer offices and engine-generator mezzanine
Loading Docks: Four dock bays; two with dock levelers, one with scissor lift

COMPUTER ROOM SPECIFICATIONS

Computer Room Size: 2,700 SF/11,000 SF
Critical Power Capacity: 568.75 kW, 1,137.5 kW or 2,275 kW

DATA CENTER AREA DESCRIPTION

Computer Room Floor: 176,200 SF
Number of Computer Rooms: 28
Raised-Floor Height: 42"
Computer Room Floor-to-Ceiling Height: 15'-22"

AMENITIES

Offices: 10 pre-constructed offices
Staging: Eight rooms
Miscellaneous: Wi-Fi, conference rooms, break room and shower room with lockers

SECURITY

Building and Perimeter: Fully monitored by CCTV cameras and security officer patrols
Security Officers: 24 x 7 x 365
Access Control: Electronic security features with access card entry and dual authentication with biometric readers
CCTV: Yes (minimum 95-day video retention)

CRITICAL POWER

Total Megawatts: 36.4

UPS SYSTEMS

Thirty-two 1,300 kW rotary UPS units
Redundancy: N+2, each phase

GENERATORS

Thirty-two 2,250 kW diesel-engine generators
Redundancy: N+2, each phase

ONSITE FUEL CAPACITY

Storage Tanks: Four 50,000-gallon underground diesel-fuel storage tanks
Fuel Run Time: Minimum 55 hours

HEAT REJECTION SYSTEMS (HVAC)

16 centrifugal chillers, each with 1,080-ton capacity
Redundancy: N+2, each phase
Chilled-Water Storage: Two 500,000-gallon above-ground chilled-water storage tanks

PDU's

Voltage: 208/120 V
Redundancy: N+2

COMMUNICATIONS

POE: Four separate network POEs with diverse underground duct banks leading into the facility
Conduits: Dedicated underground conduits to each computer room
Multiple Carriers: DFT is carrier-neutral
Meet-Me-Room: Two MMRs, redundant power and cabinet options for lit equipment
Telecom Ductbanks: Tri-lateral underground duct bank extending 15,000 feet offsite
Internet Exchange: AMS-IX
Certification: Open-IX

FIRE PROTECTION

Double interlocked pre-action sprinkler system with VESDA monitoring system standard



1212 NEW YORK AVE, NW SUITE 900
WASHINGTON, DC 20005

WWW.DFT.COM | 202.728.0044

About DuPont Fabros Technology

DFT designs, builds and operates wholesale data centers nationwide. We help clients across various industries make smart IT decisions that match their business goals, including managing growth, gaining more control over their infrastructure, lowering operating costs and adding data center capacity quickly.